



## FINNISH SAUNA JFP150

### Specifications and assembly instructions

#### SPECIFICATIONS



Model	JFP150
Dimensions	1500x1300x2000 mm
Number of persons	4
Wood	Finnish pine, 48 mm
Glass	Transparent, tempered, 8 mm
Hinges	Stainless Steel
Control	Touch control panel
Operating time	Up to 90 min
Temperature	Up to 90 °C
Ventilation	Yes
Connectivity	Bluetooth, Radio, App
Lighting	LED RGB starry sky
Oven	4.5 kW, with thermostat, timer and volcanic stone
Connection	Single phase 230 V, 50 Hz, conductor 3 x 4 mm <sup>2</sup> and 25 A fuse Three phase 400 V, conductor 5 x 2,5 mm <sup>2</sup> and 3 x 16 A fuse
Weight	275 kg

## COMPONENTS

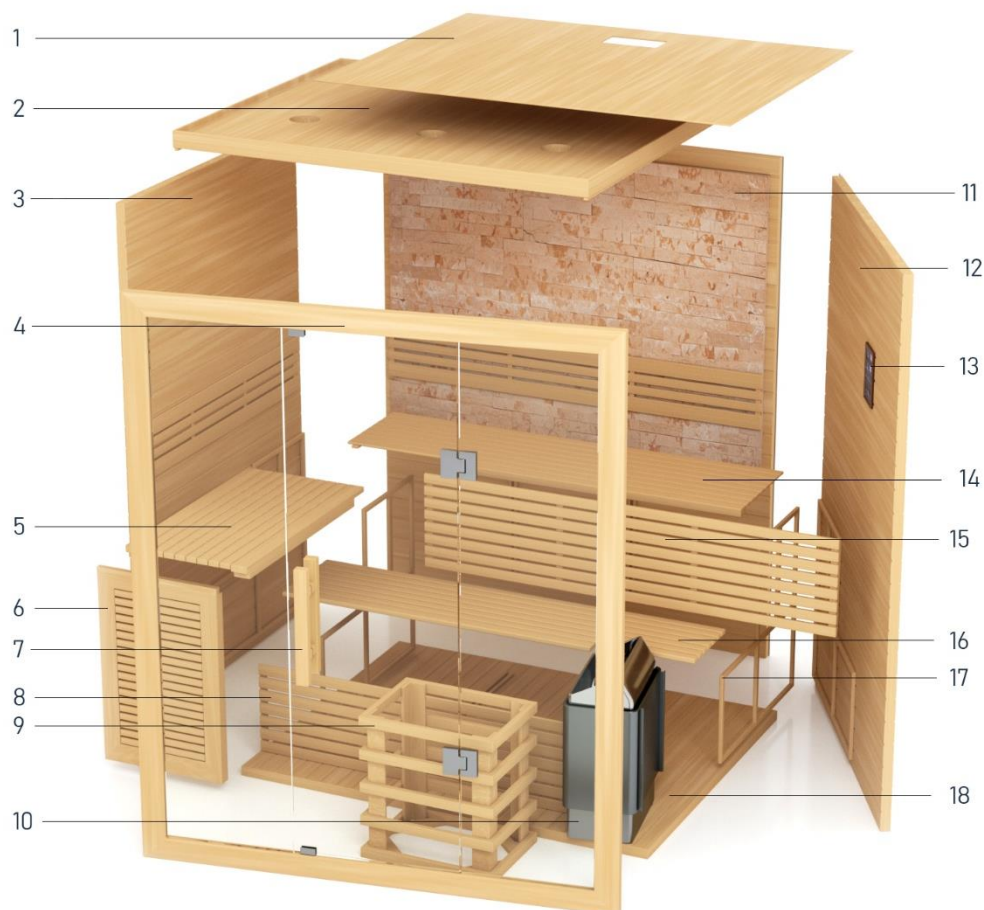

- |                                 |                                  |
|---------------------------------|----------------------------------|
| 1 Cover plate                   | 10 Stove                         |
| 2 Ceiling panel                 | 11 Back plate                    |
| 3 Left side                     | 12 Right side                    |
| 4 Front panel with glass        | 13 Control panel                 |
| 5 Left upper bench              | 14 Upper bench                   |
| 6 Bench side                    | 15 Front side of the upper bench |
| 7 Handle                        | 16 Lower bench                   |
| 8 Front side of the lower bench | 17 Bench holders                 |
| 9 Stove frame                   | 18 Bottom                        |

## RECOMMENDED TOOLS



Screwdriver



Meter



Screwdriver

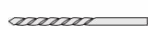

Screws



Water scale



Imbus key



A knife



A ladder

## ASSEMBLY TIPS

Please remove the transport packaging and check that your sauna has been delivered complete and undamaged before starting assembly. At least two people are needed to assemble the sauna.

## ASSEMBLY STEPS





1. Back plate



2. Right side



3. Left side



4. Bottom



5. Bench holders



6. The front side of the lower bench



7. Bench



8. The front side of the upper bench



9. Upper bench



10. Bench side



11. Left upper bench



12. Front panel with glass



13. Handle



14. Stove and stove frame



15. Ceiling panel



16. Cover plate

## Installing the outer buckle

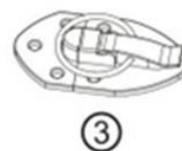
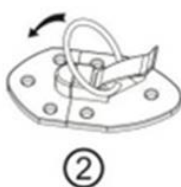
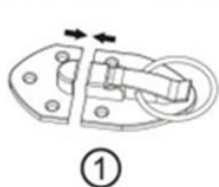

## Connecting electrical components



1. Connect the blue UTP cable from the control panel to the sauna control unit..



2. Connect the power cables between the control unit and the stove.

## Installation of hinges, handle and cover



1. Install hinges



2. Install the handle



3. Install the cover plate



## CONNECTING THE STOVE TO THE ELECTRICAL NETWORK

AC out is connected to the stove without grounding. (GRND)



AC in - conductor 5 x 2.5 mm<sup>2</sup> (supplied by customer)

AC out – cable (included with purchase), which goes along the side to the furnace.

Contact cable between control plates and stove.

230 V Schuko plug

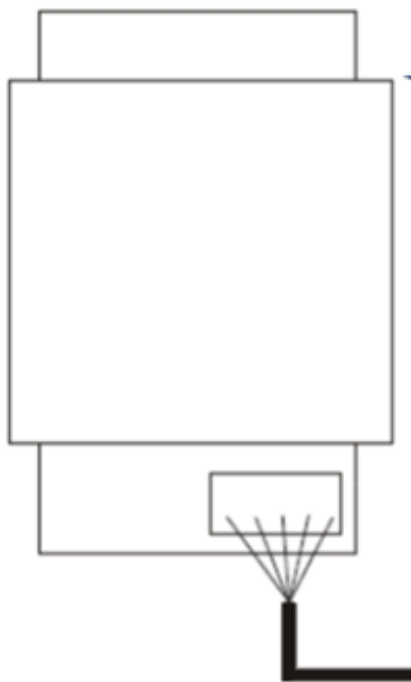

Removing information plate enables connection



UTP cable (communication between control panel and control unit)



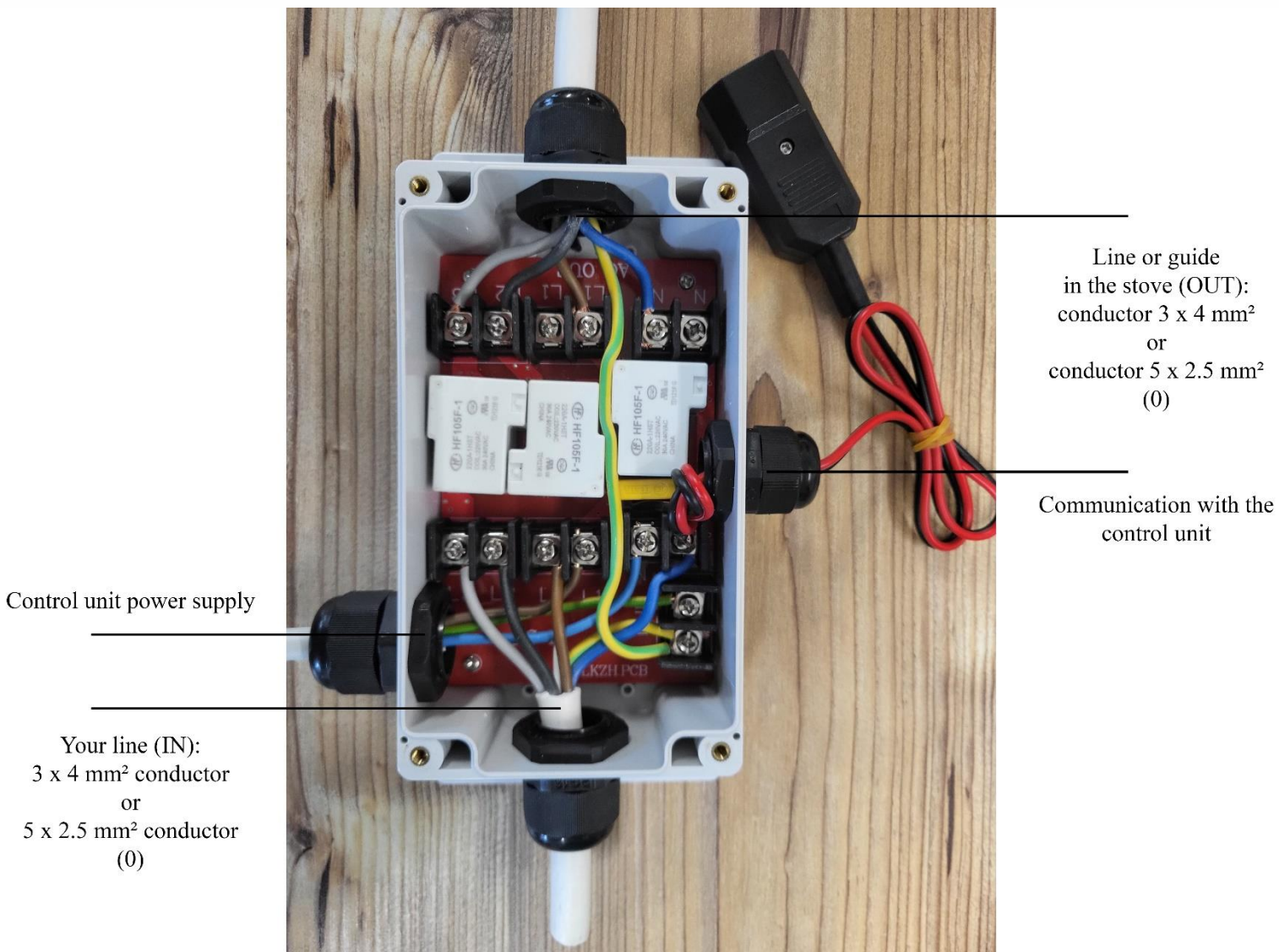

Control unit power supply

Your line (IN):  
3 x 4 mm<sup>2</sup> conductor  
or  
5 x 2.5 mm<sup>2</sup> conductor  
(0)

Line or guide  
in the stove (OUT):  
conductor 3 x 4 mm<sup>2</sup>  
or  
conductor 5 x 2.5 mm<sup>2</sup>  
(0)

Communication with the  
control unit



# WIRING DIAGRAM

